

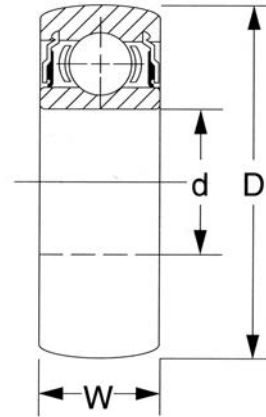

# BALL BEARINGS

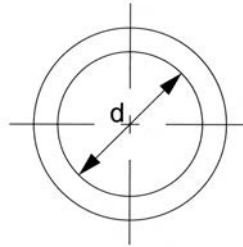

## CS 200 Series Spherical O.D. Ball Bearings



Unit Number	d		D		W		Load Ratings Lbf / N		Weight Lbs kg
	nominal In. mm	Tol. +0/ to minus In. mm	nominal In. mm	Tol. +0/ to minus In. mm	nominal In. mm	Tol. +0/ to minus In. mm	Dynamic	Static	
CS 202 DDU	0.5906 15.000	0.0003 0.008	1.3780 35.000	0.0005 0.013	0.4331 11.000	0.0050 0.127	<b>1730</b> 7690	<b>850</b> 3780	<b>0.10</b> 0.045
CS 203 DDU	0.6693 17.000	0.0003 0.008	1.5748 40.000	0.0005 0.013	0.4724 12.000	0.0050 0.127	<b>2160</b> 9600	<b>1000</b> 4440	<b>0.14</b> 0.064
CS 204 DDU	0.7874 20.000	0.0004 0.010	1.8504 47.000	0.0005 0.013	0.5512 14.000	0.005 0.127	<b>2900</b> 12890	<b>1410</b> 6270	<b>0.23</b> 0.105
CS 205 DDU	0.9843 25.000	0.0004 0.010	2.0472 52.000	0.0005 0.013	0.5906 15.000	0.005 0.127	<b>3150</b> 14000	<b>1610</b> 7160	<b>0.28</b> 0.127
CS 206 DDU	1.1811 30.000	0.0004 0.010	2.4409 62.000	0.0005 0.013	0.6299 16.000	0.005 0.127	<b>4370</b> 19420	<b>2320</b> 10310	<b>0.43</b> 0.195
CS 207 DDU	1.3780 35.000	0.0005 0.013	2.8346 72.000	0.0005 0.013	0.6693 17.000	0.005 0.127	<b>5770</b> 25640	<b>3150</b> 14000	<b>0.64</b> 0.291
CS 208 DDU	1.5748 40.000	0.0005 0.013	3.1496 80.000	0.0005 0.013	0.7087 18.000	0.005 0.127	<b>7340</b> 32620	<b>3650</b> 16220	<b>0.82</b> 0.373
CS 209 DDU	1.7717 45.000	0.0005 0.013	3.3465 85.000	0.0006 0.015	0.7480 19.000	0.005 0.127	<b>7350</b> 32670	<b>4150</b> 18440	<b>0.90</b> 0.409
CS 210 DDU	1.9685 50.000	0.0005 0.013	3.5433 90.000	0.0006 0.015	0.7874 20.000	0.005 0.127	<b>7880</b> 35020	<b>4650</b> 20670	<b>1.01</b> 0.459
CS 305 DDU	0.9843 25.000	0.0004 0.010	2.4409 62.000	0.0005 0.013	0.6693 17.000	0.005 0.127	<b>5000</b> 22220	<b>2600</b> 11560	<b>0.52</b> 0.236
CS 306 DDU	1.1811 30.000	0.0004 0.010	2.8246 72.000	0.0005 0.013	0.7480 19.000	0.005 0.127	<b>6550</b> 29110	<b>3650</b> 16220	<b>0.75</b> 0.355
CS 307 DDU	1.3780 35.000	0.0005 0.013	3.1496 80.000	0.0005 0.013	0.8268 21.000	0.005 0.127	<b>7500</b> 33330	<b>4300</b> 19110	<b>1.02</b> 0.464
CS 308 DDU	1.5748 40.000	0.0005 0.013	3.5433 90.000	0.0006 0.015	0.9055 23.000	0.005 0.127	<b>9650</b> 42890	<b>5600</b> 24890	<b>1.41</b> 0.641
CS 309 DDU	1.7717 45.000	0.0005 0.013	3.9370 100.000	0.0006 0.015	0.9843 25.000	0.005 0.127	<b>12000</b> 53330	<b>7100</b> 31560	<b>1.89</b> 0.859
CS 310 DDU	1.9685 50.000	0.0005 0.013	4.3307 110.000	0.0006 0.015	1.0630 27.000	0.005 0.127	<b>14000</b> 62220	<b>8500</b> 37780	<b>2.45</b> 1.114