

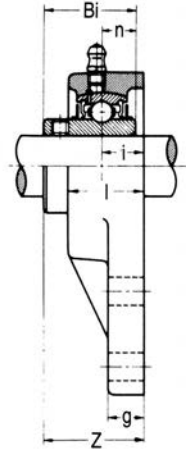

# BEARING UNITS

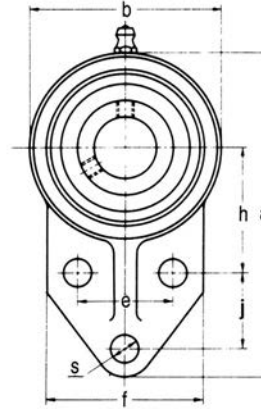

## THREE BOLT FLANGE BRACKET UNITS - Inch Bolt Hole Spacing UCFB 200 Series Normal Duty Set Screw Locking



Unit No.	Shaft Dia. In. mm	Dimensions inch / mm												Bolt Size	Bearing No.	Housing No.	Weight Lbs kg			
		a	h	e	j	i	g	l	s	b	f	z	Bi					n		
UCFB 201-8	1/2																	UC 201-8		
202-10	5/8	4-1/4	1-11/16	1-1/2	7/8	5/8	5/16	1	13/32	2-1/2	2-3/8	1-11/32	1.220	0.500	5/16		UC 202-10	FB 204	1.54	
204	20	108.0	42.9	38.1	22.2	15.9	7.9	25.4	10.3	63.5	60.3	34.1	31.0	12.7	M8		204		0.70	
204-12	3/4																UC 204-12			
UCFB 205	25																UC 205			
205-14	7/8	4-3/4	1-13/16	1-5/8	1-1/8	21/32	3/8	1-1/8	13/32	2-3/4	2-1/2	1-7/16	1.339	0.563	5/16		UC 205-14	FB 205	1.76	
205-15	15/16	120.7	46.0	41.3	28.6	16.7	9.5	28.6	10.3	69.9	63.5	36.5	34.0	14.3	M8		205-15		0.8.0	
205-16	1																205-16			
UCFB 206	30																UC 206			
206-17	1-1/16	5-3/8	2-1/16	1-7/8	1-1/4	47/64	3/8	1-1/4	13/32	3-1/4	2-3/4	1-39/64	1.500	0.626	5/16		UC 206-17	FB 206	2.20	
206-18	1-1/8	136.5	52.4	47.6	31.8	18.7	9.5	31.8	10.3	82.6	69.9	40.9	38.1	15.9	M8		206-18		1.00	
206-19	1-3/16																206-19			
206-20	1-1/4S																206-20			
UCFB 207	35																UC 207			
207-20	1-1/4	6-1/8	2-3/8	2	1-1/4	13/16	1/2	1-7/16	33/64	3-3/4	3-1/4	1-53/64	1.689	0.689	3/8		UC 207-20	FB 207	2.86	
207-21	1-5/16	155.6	60.3	50.8	31.8	20.6	12.7	36.5	13.1	95.3	82.6	46.4	42.9	17.5	M10		207-21		1.30	
207-22	1-3/8																207-22			
207-23	1-7/16																207-23			
UCFB 208	40																UC 208			
208-24	1-1/2	6-15/32	2-3/8	1-31/32	1-5/8	13/16	5/8	1-13/32	33/64	3-31/32	3-1/16	2-1/64	1.937	0.748	3/8		UC 208-24	FB 208	3.08	
208-25	1-9/16	164.3	60.3	50.0	41.3	20.6	15.9	35.7	13.1	100.8	77.8	51.2	49.2	19.0	M10		208-25		1.40	
UCFB 209	45																UC 209			
209-26	1-5/8	6-27/32	2-9/16	2-1/8	1-11/16	55/64	23/32	1-1/2	33/64	4-15/64	3-5/32	2-1/64	1.937	0.748	3/8		UC 209-26	FB 209	4.84	
209-27	1-11/16	173.8	65.1	54.0	42.9	21.8	18.3	38.1	13.1	107.6	80.2	51.2	49.2	19.0	M10		209-27		2.2.0	
209-28	1-3/4																209-28			
UCFB 210	50																UC 210			
210-30	1-7/8	7-1/2	2-15/16	2-3/4	1-5/8	55/64	1/2	1-1/2	33/64	4-5/8	4	2-7/64	2.031	0.748	3/8		UC 210-30	FB 210	5.50	
210-31	1-15/16	190.5	74.6	69.9	41.3	21.8	12.7	38.1	13.1	117.5	101.6	53.6	51.6	19.0	M10		210-31		2.50	
210-32	2S																210-32			