

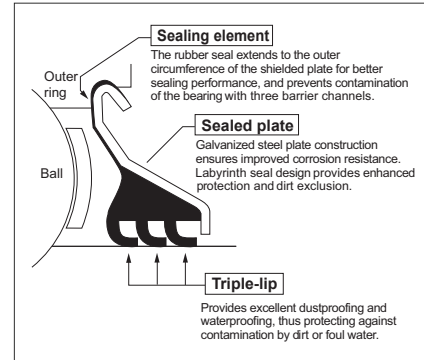

CORROSION RESISTANT PRODUCTS

TRIPLE-LIP BLACK OXIDE INSERT BEARINGS Eccentric Collar Locking

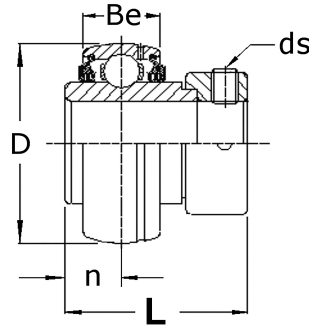

Insert Part No.	Shaft Diameter Inch	Dimensions inch / mm					Basic Load Ratings lbf / N		Weight Lbs kg
		D	L	Be	n	ds	dynamic C	static Co	
HC205-16R3BO	1	2.04724 52.0	1-3/8 34.9	21/32 16.7	11/16 17.5	1/4-28UNF M6x1.0	3150 14000	1700 7560	0.51 0.23
HC206-19R3BO	1-3/16	2.44094 62.0	1-7/16 36.5	3/4 19.1	23/32 18.3	5/16-24UNF M8x1.0	4390 19510	2510 11160	0.79 0.36
HC206-20R3BO	1-1/4S								0.88 0.40
HC207-20R3BO	1-1/4	2.83465 72.0	1-31/64 37.7	25/32 19.8	3/4 19.1	5/16-24UNF M8x1.0	5770 25640	3450 15340	1.45 0.66
HC207-22R3BO	1-3/8								1.34 0.61
HC207-23R3BO	1-7/16								1.28 0.58
HC208-24R3BO	1-1/2	3.14961 80.0	1-11/16 42.9	13/16 20.6	27/32 21.4	5/16-24UNF M8x1.0	6500 28890	3850 17110	1.89 0.86
HC209-28R3BO	1-3/4	3.34646 85.0	1-11/16 42.9	7/8 22.2	27/32 21.4	5/16-24UNF M8x1.0	7350 32670	4100 18225	1.87 0.85
HC210-31R3BO	1-15/16	3.54331 90.0	1-15/16 49.2	15/16 23.8	31/32 24.6	5/16-24UNF M8x1.0	7900 35120	4690 20850	2.27 1.03
HC210-32R3BO	2S								2.09 0.95
HC211-32R3BO	2	3.93701 100.0	2-3/16 55.6	31/32 24.6	1-3/32 27.8	3/8-24UNF M10x1.25	9750 43340	5850 26000	3.28 1.49