



BEARING UNITS



RUBBER CARTRIDGES - Cylindrical OD - Vibration Damping

Normal Duty
Set Screw Locking

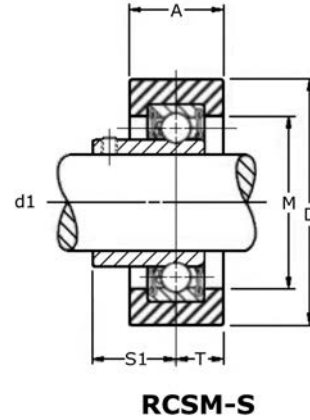

RSCM-S

RSCM-S

* Also Available with Eccentric Collar Lock in 200 Series Part Numbers.
Example - RSCM-12 assembled with Bearing No. CSA204-12 instead of CSB204-12.

Unit No.	Shaft Dia.	Dimensions (mm)								Bearing No.	Rubber No.	Housing Radial Load Rating	Weight
	In.	D	A	A1	G	M	d1	S1	T			Lbf N	Lbs kg
RCSM-S SERIES													
RCSM-8S	1/2	2-17/32	1	-	-	1-3/8	1-1/8	7/8	1/2	CSB 201-8	RCSM 40/65	200	0.83/0.377
RCSM-10S	5/8	64.3	25.4			34.9	28.6	22.2	12.7	CSB 202-10		880	0.81/0.367
RCSM-12S	3/4	2-17/32	1	-	-	1-9/16	1-5/16	59/64	1/2	CSB 204-12	RCSM 47/65	250	0.98/0.445
		64.3	25.4			39.7	33.3	23.4	12.7			1120	
RCSM-14S	7/8									CSB 205-14	RCSM 52/65		1.11/0.504
RCSM-15S	15/16	2-17/32	1	-	-	1-25/32	1-1/2	59/64	1/2	CSB 205-15		300	1.11/0.504
RCSM-16S	1	64.3	25.4			45.2	38.1	23.4	12.7	CSB 205-16		1340	1.06/0.481
RCSM-17S	1-1/16									CSB 206-17	RCSM 62/79		1.62/0.735
RCSM-18S	1-1/8	3-3/32	1-3/16	-	-	1-7/8	1-3/4	1-3/32	19/32	CSB 206-18		300	1.60/0.726
RCSM-19S	1-3/16	78.6	30.2			47.6	44.4	27.7	15.1	CSB 206-19		1340	1.58/0.717
RCSM-20S	1-1/4S									CSB 206-20			1.56/0.708
		+ RCSM Series part numbers are complete assemblies. + Cylindrical OD insert bearing mounted in rubber cushion. + Static conductive rubber cushion dampens vibrations. + Standard Part Number is eccentric collar locking type.											